





509/220 Mona Vale Road St Ives NSW

2  2  1 

Two Bedrooms plus Study -- 'Verde' complex Conveniently located to St Ives Village and city express transport.

- * Two good sized bedrooms, all with built-in wardrobes
- * Located at rear and quiet side of building , North East facing
- * Two bathrooms, master with ensuite
- * Spacious open-plan lounge/dining to spacious balcony with Garden outlook
- * Modern kitchen with Caesar Stone bench tops
- * Air conditioning available to all rooms
- * Gym, sauna facilities and visitor parking
- * Minutes from public transport, local schools and a great selection of nearby shops, restaurants and cafes

View : <https://www.savillsresidential.com.au/lease/nsw/north-shore-upper/st-ives/residential/apartment/6681194>



Julie Zhu
0429 629 259



Mara Iskenderian
02 9416 9393

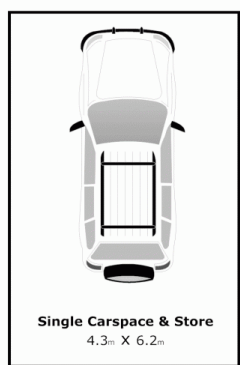

509/220-222 Mona Vale Rd

St Ives

Internal Floor Area appx: 89.2m²

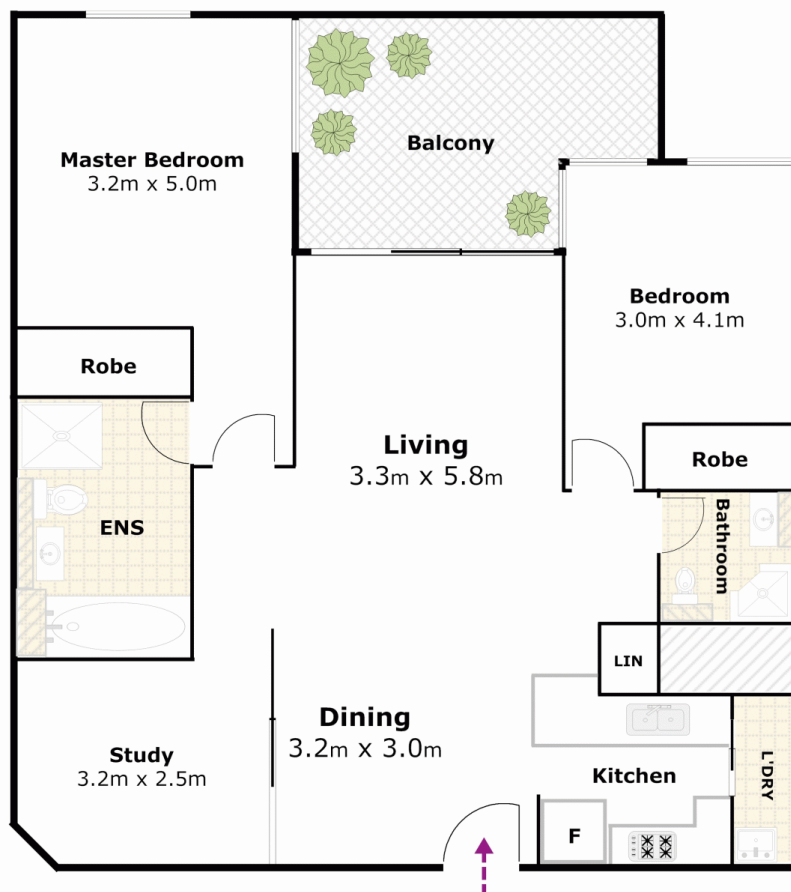

Balcony Area appx: 10.8m²

Carspace Area & Store appx: 21m²

All dimensions shown are approximate and should only be used as a guide. Not to scale.