



**5/73-75 Telegraph Road Pymble NSW**

4 3 2

A rare opportunity for a discerning owner to enjoy the exclusive lifestyle benefits of this imaginatively designed, chic & elegant development for the over 55's. Its superior and highly desirable location on one of the most prestigious streets in Pymble, provides easy access to the nearby St Ives village shops, golf course & club-house, restaurants & cafes.

**Price** : Price on application  
**View** : <https://www.savillsresidential.com.au/sale/nsw/north-shore-upper/pymble/residential/townhouse/7838739>

- ? Individual, private electric traction elevator to all levels from accessible basement parking
- ? Spacious internal passageways and stairwell with void offering a generous sense of place
- ? Ground floor living flows onto private courtyard and gardens bathed in natural light
- ? Smart-home technology and security features with controlled access and back to base system
- ? Kitchen features fully integrated appliances including



**Chris Orr**  
**02 9416 9393**

# 5 RESIDENCE

73-75 TELEGRAPH ROAD  
PYMBLE



4 Bedrooms | 3 Bathrooms | 2 Storeys

Interior Area / 172 sqm  
Exterior Area / 90 sqm

- North & West Aspects
- Sweeping Telegraph Road Terraced Views
- Private Elevator to Every Level
- Master Bedroom and Sitting Room
- Private Technology Network
- Natural Cross Ventilation
- Variable Ducted Air Conditioning
- Natural Travertine & Marble

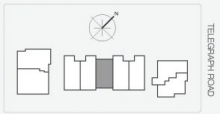

TELEGRAPH ROAD

1800 001 186

[www.telegraphresidences.com](http://www.telegraphresidences.com)

All dimensions are approximate and subject to normal construction variances and tolerances. Furniture and placement are for illustrative purposes only. Plans, dimensions and joinery detail may contain minor variations from floor to floor. Any square metre measurements on this floor plan is approximate of the strata survey space. The Vendor reserves the right to make changes in accordance with construction, building or statutory requirements to achieve compliance.

